



ScanRix® Water Technology SWT 5000

Vandrenser med omvendt osmose

Denne manual er på engelsk. Læs venligst manualen grundigt inden du tager produktet i brug. Ring eller skriv til din forhandler, hvis du er i tvivl om brugen af produktet.

Contents

1.Safety Precautions and packing list.....	01
2.Function and technical parameters.....	02
3.Product appearance and LCD display.....	03
4.Electrical schematics and producing water technical flowchart.....	04
5.Function of filter cartridge and Installation.....	05
6.Usage.....	06
7.Use instructions and replacement filter cartridge.....	07
8.Common use phenomenon.....	09
9Terms of warranty.....	12

Safety Precautions and packing list

Warning: This symbol reminds the user that the operation is dangerous or harmful to the body

Attention: This symbol reminds the user that the operation is an important operation or maintenance instruction for the product

Do not disassemble or modify this machine by yourself, otherwise it will make water leakage or malfunction

Do not change the electric cable by yourself. If the electric cable is damaged, please change it by the person which are our company authorized.

Do not put the heavy object on the water dispenser, otherwise, it will damage the water dispenser, then make leakage

Do not put the machine under the sunlight and outdoors, or put the machine in the place the temperature below 0°C

When the machine malfunctions, please cut off the power quickly

Do not put the place the children can reach.

Use it in dry place the temperature between 4-40°C

Please turn off when you don't use the machine in 24 hours

Please use our company accessories and filter cartridge when it needs to change

Please clear the water in all the tank, when you move the machine

When press the mike button, please check if the temperature is comfortable, to prohibit scald

Please release the normal water first, then release other hot water when you first using or using after the power off

Packing List

No.	Name	Amount
1	Ro water dispenser	1
2	manual	1
3	Base	1
4	Tank	1
5	Warranty Card	1

Function and technical parameters

This machine is countertop type, no need to install, connect with the power switch, four type temperature, meet all demands; use the reverse osmosis technology, guarantee the water is clean, enjoy the healthy life from the design and new technology. The computer board in the machine can control the water quality, four stage purification, remove the heavy metal/organic, reduce the salt, make the water soften. The appearance is classic and simple, stylish and generous, can be integrated with modern decoration

Rated voltage	220V
Rated frequency	50Hz
Rated power	2300W
Power consumption	0.1KW.H/24H
Pure water flow rate	130ml/min(25°C)
Hot water capacity	27L/H(≥90°C)
Rated pure water	2000L
Original water tank	5L
Pure water tank	1.5L
Operating temperature	4-40°C
Operating humidity	≤90%
Water temperature	5-38°C
Type of protection against electric shock	I
IP code of water proof	IPX4
Original water	Tap water
NW/GW	7kg/9kg
Executive standard	GB4706.1-2005 GB4706.19-2008 QB/T4144-2010 Q/MY002-2017
Water quality	Meets the government standard

Product appearance and LCD display

Product appearance diagram

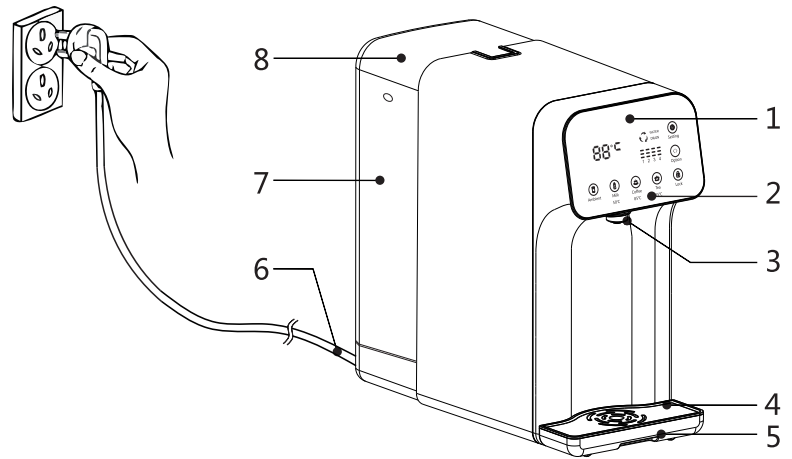

- | | | | |
|---------------|----------------|--------------|--------------|
| 1.LCD display | 2.Touch button | 3.Tap | 4.Base cover |
| 5.Base | 6.Cable | 7.Water tank | 8.Tank cap |

Product appearance diagram

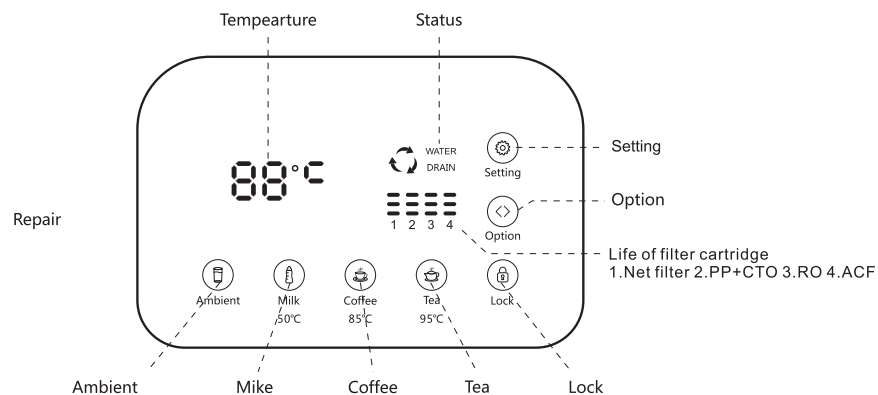

3

Electrical schematics and producing water technical flowchart

Electrical schematics

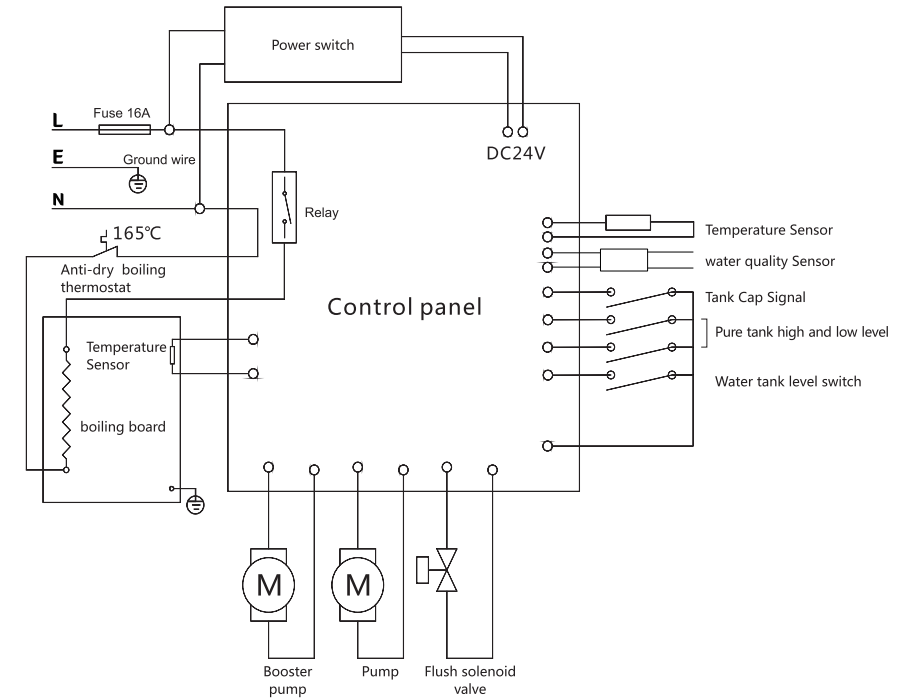

producing water technical flowchart

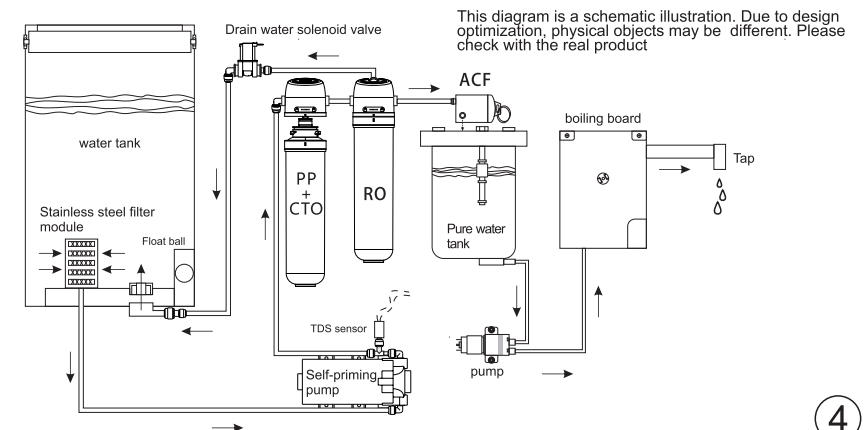

4

Function of filter cartridge and Installation

Function of filter cartridge

Type of filter cartridge	Function	Life
PP+CTO	Remove the particles, dust, mud, absorb the chlorine, organics, odor, smell turbidity and remove the heavy metal in the water	3-6 months.
RO membrane	remove more than 96% of all contaminants in the water	12-24 months.
ACF filter	Change the taste of the water	8-12 months.

P.S. Period of replacement differs depending on water quality.

Installation

1. Please install the water purifier in a cool, ventilated and dry place, far away from strong heat sources. It should be put on a solid flat surface. To ensure the quality of drinking water, please use original filter cartridge from our company
2. Adding water, Open the water tank cap (Photo 1), Lift up the tank, then take back the tank with full water to the machine. (Photo 2), cover the cap, if the cap does not cover completely, the machine will not work

Attention: When the machine warns "change water" or other reason that you need to lift up the water tank, you should open the tank cap, after 10 seconds, then you can lift the water tank

3. Power supply connection Insert the power plug into wall socket. The machine emits "beep" and turns on the display and touch button, what indicates that the machine is ready for working

Attention: this product is designed for AC 220V power supply ONLY, and should be used with wiring and grounded wall socket rated at 10A or more.

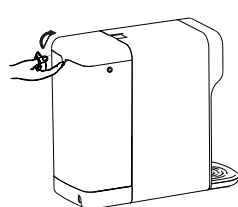

1

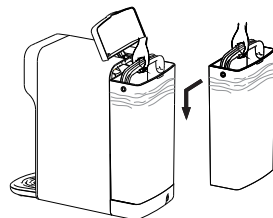

2

5

Usage

1. When you use first time, you should check if there is any leakage when the machine is working. If leak, please cut off the power, then contact with the Customer service center

Please flush the machine as below step when you first time use

- a. Fill 5L water in the water tank, then the machine is working, after the "water" light is extinguished
- b. Touch the "ambient" button, release 250ml water, then 3-4 times
- c. Then clear the drain water in the tank, fill the tank with tap water again
- d. Repeat 1-3 steps 3 times

After long time no use, please release 3 L water first, then can drink. If the machine has abnormal sound, smell, or smoke, etc, please cut off the power immediately and contact customer service center.

2. Flushing. The machine will be flushing 120 seconds as the first time use. When the machine is flushing, the signal "Water" will be flashing on the LCD display

3. Water, after flushing, it will make water, when the machine is making water status, the signal "water" will be light on the LCD display

4. Drain. When the signal "drain" is flashing, the water level in the tank is below the limited level (dotted line), you should change the water in the tank, when the signal "drain" is light, it shows the water quality is not good enough, you should change the water

5. Getting water. Put the cup or bottle above the base, touch the children lock, after the children lock is light, then touch the button which the temperature you need, after finish, please touch any button, it will be stop. (The ambient water does not need the children lock)

Attention 1. Normally we set one time release water 250ml, for hot water, you should unlock the children lock first

2. If getting hot water, please do not put your hand below the tap to avoid burns

3. To prevent the dry boiling, please release some ambient water first when you first time use

6. Sleep mode

After the completion of water purification or if there is no user activity within 5 minutes, the machine will automatically enter Sleep mode. Any operation will return to work mode immediately.

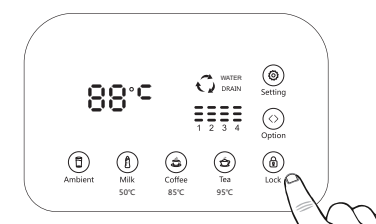

6

Function of filter cartridge and Installation

Function of filter cartridge

Type of filter cartridge	Function	Life
PP+CTO	Remove the particles, dust, mud, absorb the chlorine, organics, odor, smell turbidity and remove the heavy metal in the water	3-6 months.
RO membrane	remove more than 96% of all contaminants in the water	12-24 months.
ACF filter	Change the taste of the water	8-12 months.

P.S. Period of replacement differs depending on water quality.

Installation

1. Please install the water purifier in a cool, ventilated and dry place, far away from strong heat sources. It should be putted on a solid flat surface. To ensure the quality of drinking water, please use original filter cartridge from our company
2. Adding water, Open the water tank cap (Photo 1), Lift up the tank, then take back the tank with full water to the machine. (Photo 2), cover the cap, if the cap do not cover completely, the machine will be not work

Attention: When the machine warning "change water" or other reason that you need to lift up the water tank, you should open the tank cap, after 10 seconds, then you can lift the water tank

3. Power supply connection Insert the power plug into wall socket. The machine emits "beep" and turns on the display and touch button, what indicates that the machine is ready for working

Attention: this product is designed for AC 220V power supply ONLY, and should be used with wiring and grounded wall socket rated at 10A or more.

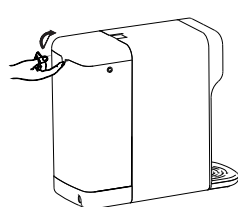

1

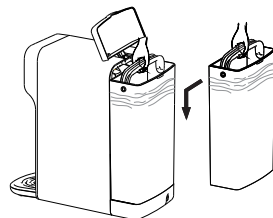

2

5

Usage

1. When you use first time, you should check if there is any leakage when the machine is working. If leak, please cut off the power, then contact with the Customer service center

Please flush the machine as below step when you first time use

- a. Fill 5L water in the water tank, then the machine is working, after the "water" light is extinguished
- b. Touch the "ambient" button, release 250ml water, then 3-4 times
- c. Then clear the drain water in the tank, fill the tank with tap water again
- d. Repeat 1-3 steps 3 times

After long time no use, please release 3 L water first, then can drink. If the machine have abnormal sound, smell, or smoke, etc, please cut off the power immediately and contact customer service center.

2. Flushing. The machine will be flushing 120 second as the first time use. When the machine are flushing, the signal "Water" will be flashing on the LCD display

3. Water, after flushing, it will make water, when the machine are making water status, the signal "water" will be light on the LCD display

4. Drain. When the signal "drain" is flashing, the water level in the tank is below the limited level (dotted line), you should change the water in the tank, when the signal "drain" is light, it shows the water quality is not good enough, you should change the water

5. Getting water. Put the cup or bottle above the base, touch the children lock, after the children lock is light, then touch the button which the temperature you need, after finish, please touch any button, it will be stop. (The ambient water do not need the children lock)

Attention 1. Normally we set one time release water 250ml, for hot water, you should unlock the children lock first

2. If getting hot water, please do not put your hand below the tap to avoid burns

3. To prevent the dry boiling, please release some ambient water first when you first time use

6. Sleep mode

After the completion of water purification or if there is no user activity within 5 minutes, the machine will automatically enter Sleep mode. Any operation will return to work mode immediately.

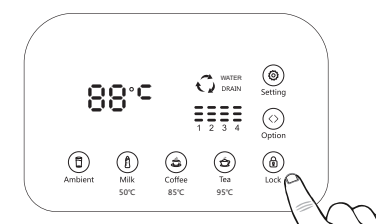

6

Use instructions and replacement filter cartridge

1.To ensure the safety of the water you drink ,please use the filter cartridge and other replacement material from our company ,if have any abnormal problem, please contact with customer service center

2.Washing the stainless steel net

A.After 3 months use ,you should wash the stainless steel net by the brush,then can enjoy the best water quality and prolong the life of filter cartridge.

B.Please follow the below

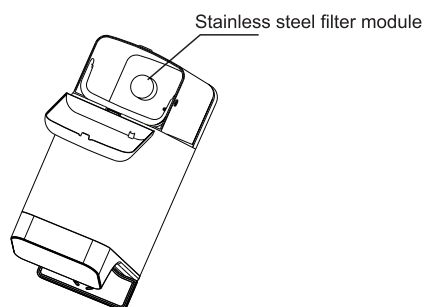

Replacement the filter cartridge and washing the net

①.Open the cap and wait 5 seconds.

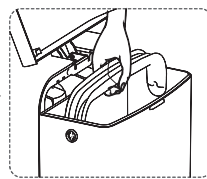
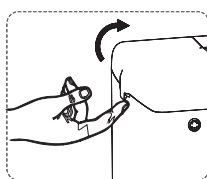

②.Take out the tank.

③.Take out the stainless steel net, and clear the surface of the net.

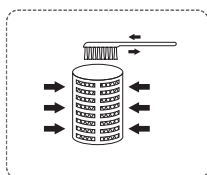

④.after clean it ,put back to the tank.

3.Replacement filter cartridge

1) The replacement and reset of PP+CTO filter cartridge,RO membrane ,ACF filter cartridge.

When the signal "Repair" is red,it shows you should change the filter cartridge, please cut off the power ,then change the filter cartridge

①Open the cap and wait 5 seconds

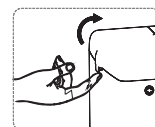

②Take out the tank

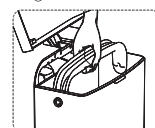

③Hold the PP+CTO filter cartridge, screw it in counter clockwise ,remove it

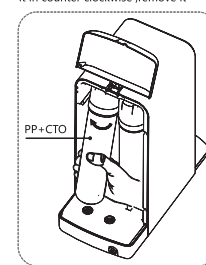

④ Hold the RO membrane filter cartridge, screw it in counter clockwise ,remove it

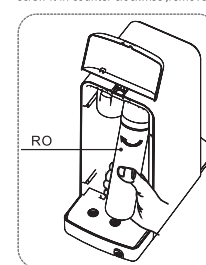

⑦Hold the new RO membrane, screw it in clockwise, after bench mark of the cap and the filter cartridge in the same level

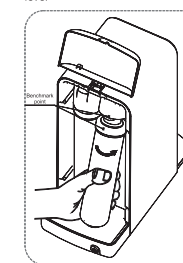

⑥Hold the new PP+CTO filter cartridge, screw it in clockwise, after bench mark of the cap and the filter cartridge in the same level

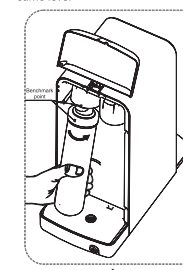

⑤Pull out the ACF filter, then insert the new one.

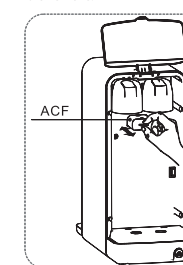

⑧Take the water tank back, cover the cap

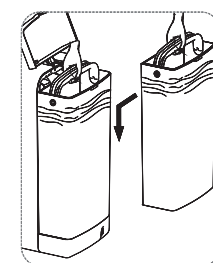

⑨Connect with the power, touch the signal "Set" button 3 seconds, then touch the signal "option" ,choose the filter cartridge which had been changed ,reset the life of the filter cartridge

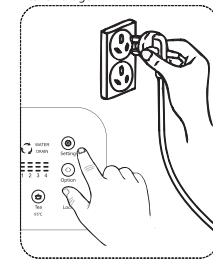

Common use phenomenon

1.Making water issue

If the machine making water long time ,do not stop ,so it is “making water issue” , then the signal “E3” will show on the LCD display,connect with the power again, can slove this problem,If can not making hot water , the singal “E1” and “E2” will show on the LCD display

2.Dry boiling warning

When the boiling board are boiling without water(the temperature is over setting), the machine is in “dry boiling alarm” status,then the signal “tea” is flashing. when the machine are in “dry boiling alarm” status,you can get ambient water , can not get hot water (milk ,coffee,tea),after release ambient water ,slove this problem

3.Overtime repair

After making water 40 minutes ,the low level switch is not close, the machine will stop to make water or flush ,do not allow to get any temperature water,the signal “overtime repair” will be flash,warning 60 times,when the float ball in the pure water tank is close,after making water 3 hours ,the float ball is not close in high level,the machine will stop working or flushing, do not allow to get any temperature water, the signal “overtime repair” will be flash,warning 60 times. Then the signal “E3” will be show on the LCD display ,show there is problem with the float ball.

Common use phenomenon

The fault phenomenon	Reason	olution
can't get ambient water	No power	Check whether the power plug is loose or not inserted.
	Pure water tank is short of water, signal “water ” long time flashing display	If the signal “drain” is flashing on the LCD display, please change the water ,after making water finish ,then drink
can't get hot water	For the first time connect the power or reconnect the power, the machine enters the "anti-dry boiling protection"	First take a small cup of ambient water, then take other hot water
	The machine is in the status of "dry boiling alarm",	Take some ambient temperature water first, then other hot water.
	Pure water tank water shortage, signal “water” is flashing on the LCD display.	Wait for a moment, and when the signal “water” is lighting, then can get hot water.
Do not make water	The original tank cover is not closed.	Check whether the water tank cover is completely close
	The water in the water tank below the dotted line,and the signal “drain” is flashing	Change water
	The original water tank is not installed completetly	Check whether the original tank is properly installed.
Smell in the water	New machine	Release 3 L water ,then can drink
	Long time no use	Release 3 L water ,then can drink
	Do not change filter cardtidge on time	Change the cartridge

The fault phenomenon	Reason	olution
Abnormal water making sounds	The water in the water tank below the dotted line,	Change water
	The water system is blocked.	Open the water tank several times, let the machine start the flusing function several times, let the air out.
	The water quality is bad and the filter cartridge is blocked	Replace the filter cartridge
Water leakage	The base is full	Clear the water in the base
	The check valve in the water tank is blocked or out	Reset the check valve in the water tank or contact with customer service to change the check valve.
	Leakage in the machine	Cut off power and contact our customer service.
leakage current	The machine is not grouding completely	There must be a threehole s-ocket with reliable grounding.
	The cable is broken	Please contact customer ser-vice.
	The hardware is damaged	Please contact customer ser-vice.
	System crash	Turn off the power 1-2 minut-es ,then connect with power again
The signal "Repair" is flashing	E1 The Temperature Sensor issue	Please contact customer service.
	E2 ,boiling board sensor issue	
	E3 The switch of float ball issue	

When the machine is not work ,please check the Common use phenomenon and solution ,if you can not slove ,please cut off the power ,contact with the customer service.

Terms of warranty

- 1.If you find the machine has some quality problems, please contact customer service or the department of your nearest authorized dealer for the maintenance.
- 2.Do not disassemble the machine by yourself! Otherwise you will lose all warra-nty rights for this machine, and the company will not assume any responsibility for the resulting quality problems or accidents.
- 3.Warranty period for this equipment is 1 year from the date of purchase.
- 4.During this period, the company is responsible for free maintenance in any case if the product has inartificial quality problem.
- 5.The company will charge for the parts and maintenance of the equipment if it exceeds the guarantee period or the product breaks down due to artificial damage.
- 6.The filter cartridge will charge when you change it
- 7.Please keep the user's warranty card, product certificate and the receipt from the shop for maintenance.